



ALINA

WEST COQUITLAM

HARMONY
IS HOLISTIC

Preview Package



TRANQUILITY
BY DESIGN
—
SERENITY
BY NATURE

Harmony By Design

Alina is a vision of balance in design, pairing a timeless aesthetic with luxurious modern details that capture a sense of sophistication and elegance.

The architecture is defined by strong, clean lines that evoke clarity and precision, while contrasting colour tones convey strength and vibrancy. Inside, soft organic forms, inspired by nature, amplify the embrace of harmony.



Artist rendering. All renderings/pictures are for illustration purposes only.



SOULFUL LIVING

Wellness at Its Heart

Each detail designed with wellness in mind, for a living experience that is both sophisticated and serene. Exclusive indoor and outdoor amenities at the rooftop level are designed to nurture mental, emotional, physical, and social wellbeing. A refined and relaxed environment, surrounded by nature.



BALANCE *IN EACH* DAY

City Life with Natural Balance

Alina exists in the perfect space between urban sanctuary and natural retreat. Just the right distance from energetic urban centres, you are steps away from tree-lined trails and parks, plus seaside meadows and walking paths at nearby Rock Point in Port Moody. What a rare privilege to live so close to serene coastal beauty and dramatic mountain tops, yet just minutes from every urban convenience you could desire in the fast-evolving West Coquitlam; from shopping at Lougheed Town Centre and eclectic restaurants and cafés, to simple basics like groceries, essential services, and more.

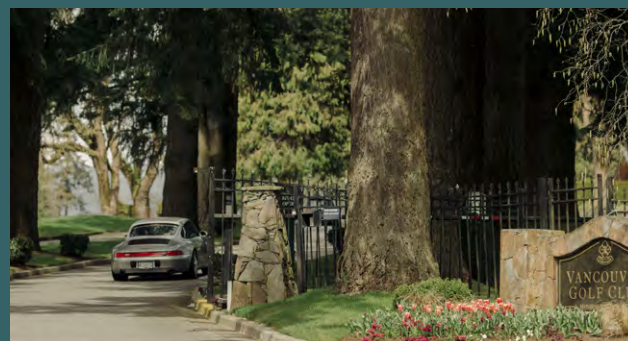
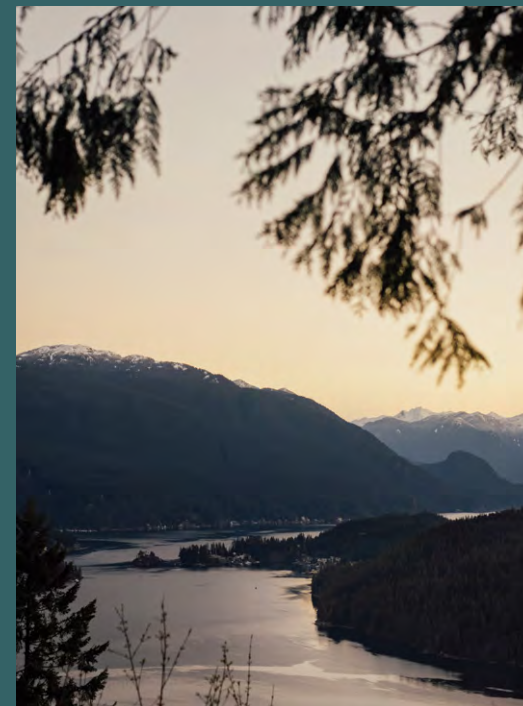



DOWNTOWN
VANCOUVER

30 MIN DRIVE — 35 MIN TRANSIT

BRENTWOOD
TOWN CENTRE

15 MIN DRIVE — 15 MIN TRANSIT

SIMON FRASER
UNIVERSITY

6 MIN DRIVE — 15 MIN TRANSIT

METROTOWN

20 MIN DRIVE — 30 MIN TRANSIT

BURNABY LAKE
REGIONAL PARK

10 MIN DRIVE

DEER LAKE PARK

15 MIN DRIVE

FUTURE STRAND
TOWER



LOUGHEED
TOWN CENTRE

7 MIN DRIVE — 7 MIN TRANSIT

BURQUITLAM
SKYTRAIN STATION

5 MIN WALK

BURNABY MOUNTAIN
PARKS & TRAILS

5 MIN WALK

BURQUITLAM
PLAZA

5 MIN WALK

FUTURE STRAND
TOWER



PORT MOODY

6 MIN DRIVE

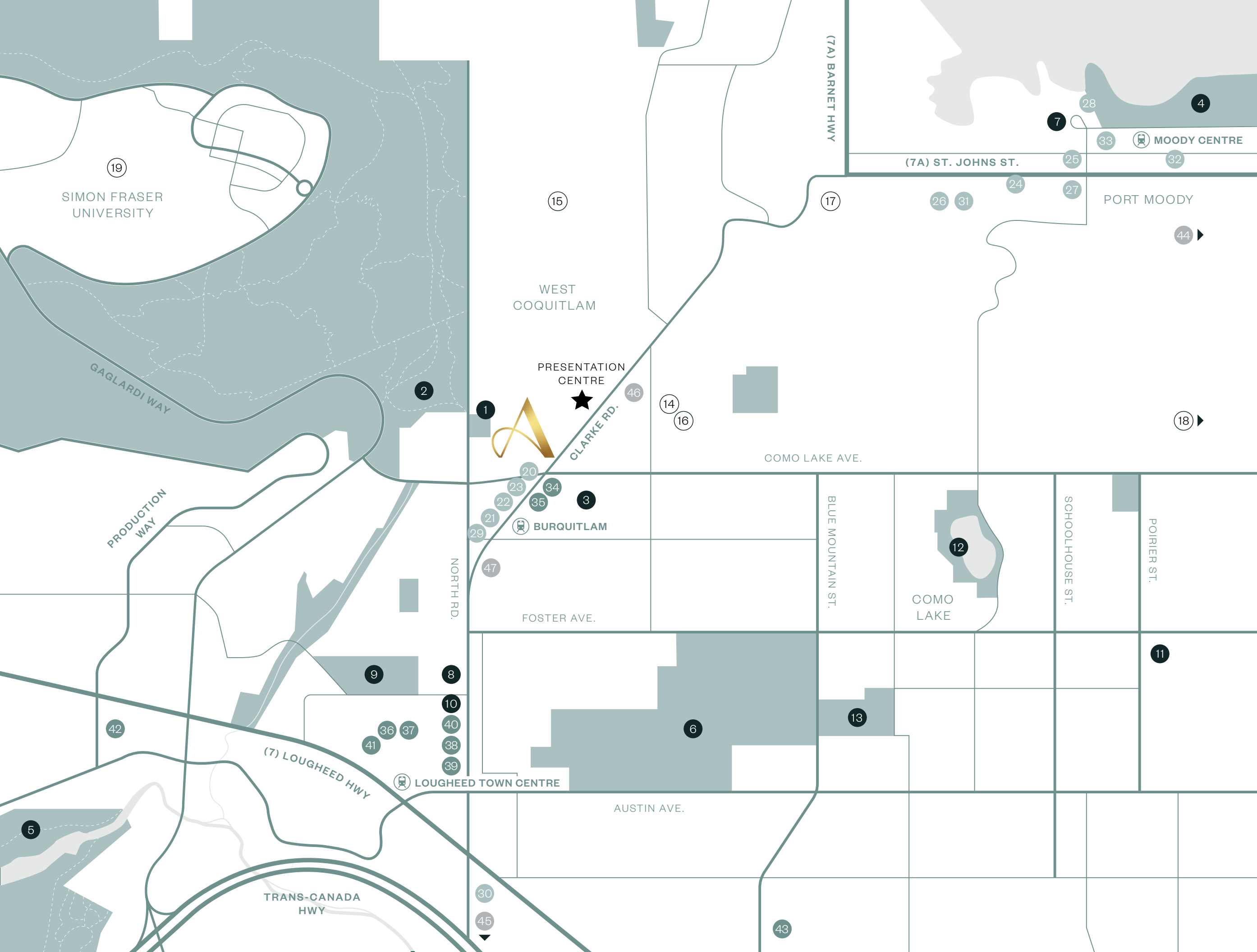
Artist rendition. All renderings/pictures are for illustration purposes only.



Transport

-  Burquitlam Station
-  Lougheed Town Centre
-  Moody Centre

Parks & Recreation

- 1** Oakdale Park
- 2** Burnaby Mountain Trails
- 3** Coquitlam YMCA
- 4** Rocky Point Park
- 5** Burnaby Lake Park
- 6** The Vancouver Golf Club
- 7** Port Moody Station Museum
- 8** Tri City Taekwondo
- 9** Cameron Recreation Complex
- 10** Goodlife Fitness
- 11** Poirier Sport & Leisure Complex
- 12** Como Lake Park
- 13** Blue Mountain Park

Schools & Education

- 14** K-5 Miller Park Elementary
- 15** K-5 Glenayre Elementary
- 16** 6-8 Banting Middle School
- 17** 9-12 Port Moody Secondary School
- 18** 9-12 Dr. Charles Best Secondary School
- 19** Simon Fraser University

Restaurants

- 20** Bjornbar Bakery
- 21** Connected Minds Custom Roasters
- 22** Katsuya Coquitlam
- 23** Grand Seasons Restaurant
- 24** Rosa's Cucina Italiana
- 25** Taps & Tacos
- 26** Little Bangkok Thai Kitchen
- 27** Pizzeria Spacca Napoli
- 28** The Boathouse Restaurant
- 29** Pho Super Bowl
- 30** Joey Coquitlam
- 31** Lougheed Wonton Restaurant
- 32** Namoo Sushi
- 33** Yellow Dog Brewing Co.

Shopping & Convenience

- 34** Safeway
- 35** Burquitlam Plaza
- 36** London Drugs
- 37** Sport Chek
- 38** BC Liquor Stores
- 39** Save On Foods
- 40** TD Canada Trust Branch & Atm
- 41** BMO Bank Of Montreal
- 42** Costco Wholesale
- 43** Ikea Coquitlam

Medical

- 44** Eagle Ridge Hospital
- 45** Royal Columbian Hospital
- 46** Burquitlam Animal Hospital Ltd.
- 47** Evergreen Rehab & Wellness

THE RESIDENCES



A HARMONY
OF SPACE
AND TONE



Artist rendition. All renderings/pictures are for illustration purposes only.





Thoughtful, bright and open kitchens create a light-filled and inviting space with quality Bosch appliances, polished quartz countertops, and air conditioning.



Artist rendering. All renderings/pictures are for illustration purposes only.



SOOTHING
HUES
OF LIGHT
AND DARK



Artistrendition. All renderings/pictures are for illustration purposes only.



LEVELS 6-27



[Download a copy](#)



Please contact our sales team for more information on the adaptable unit plans. The developer reserves the right to modify or make substitutes to the building design, specifications and floorplans should they be necessary. Renderings, views, and layouts are for illustration purposes only. Sales powered by MLA Canada Realty, E.&O.E.

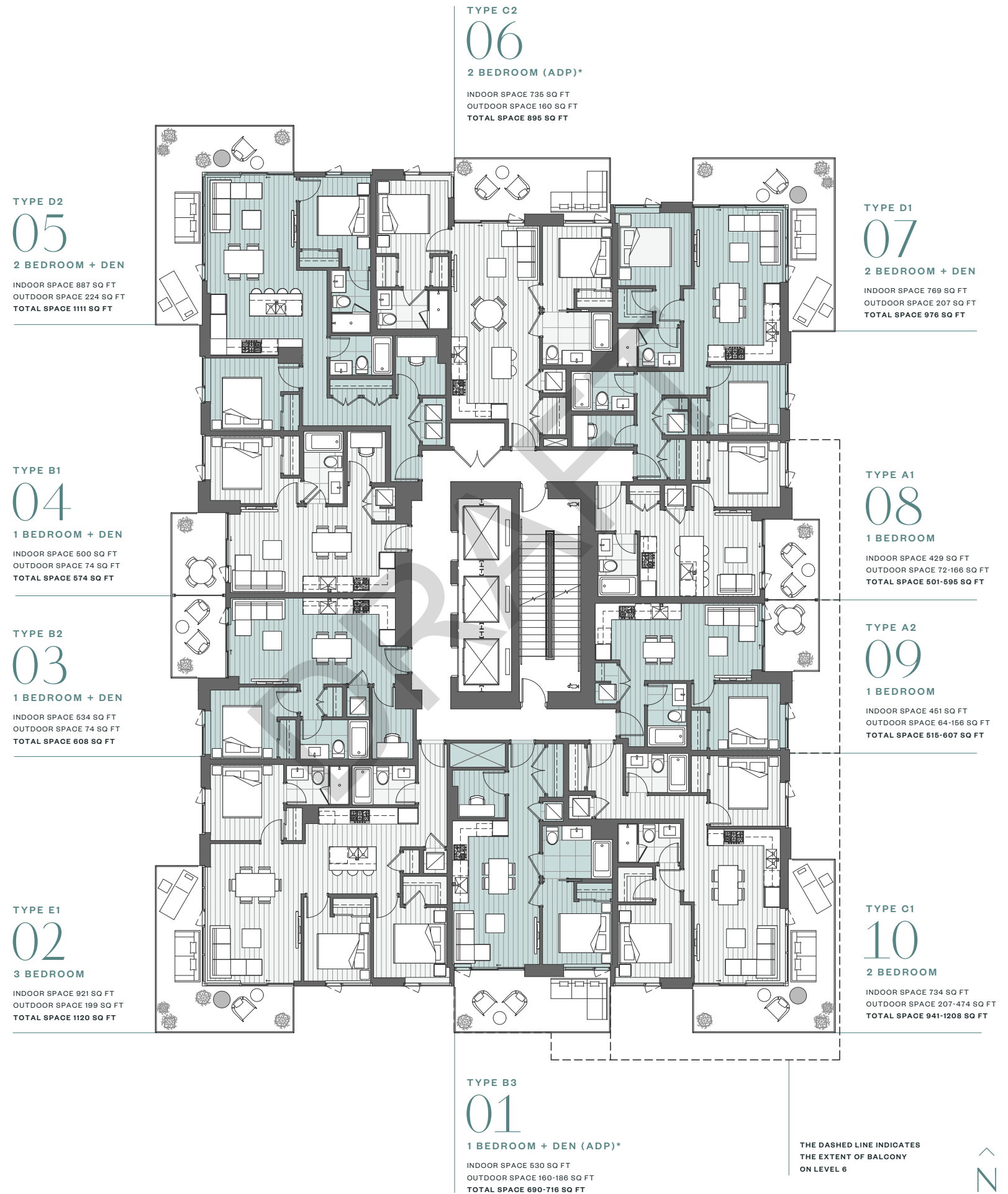



Approximate North West view
from the 27th Floor.



IMMERSED IN ELEGANCE

Welcome Home

- Impeccably designed interiors by award-winning Ste. Marie Studio
- A selection of two designer colour palettes: Sunrise & Sunset
- Airy over-height 9' ceilings
- High-quality laminate wood flooring throughout the main living area, bedrooms, closets, and den space
- Roller-shade window coverings in living, dining, and bedrooms
- Laundry closet with porcelain flooring and Samsung washer and dryer
- Air Conditioning and Heating delivered by a centralized energy-efficient variable refrigerant flow (VRF) system
- Hard-wired smoke and CO2 detectors
- Spacious balconies for all suites to maximize indoor-outdoor living

Exceptional Kitchen

- Inspiring wood-grain laminate kitchen cabinetry with recessed LED strip under-cabinet lighting
- Premium soft-close doors, Magic Corner storage system and below-sink recycling centre
- Sleek polished quartz stone countertop and porcelain backsplash
- Brushed nickel Kohler faucet with pull-down head and stainless steel under-mount sink
- Sleek AEG under-cabinet hood fan with integrated lighting
- Integrated 24" Panasonic microwave
- Integrated Bosch appliance packages including:
 - Fridge and bottom-mount freezer with integrated panelling
 - Dishwasher with integrated panel
 - 5 burner gas cooktop
 - Built-in wall oven
 - 24" package for 1BR
 - 30" package with 24" dishwasher for 2BR+

Beautiful Bathroom

- Custom wood-grain laminate medicine cabinet with integrated lighting and soft-close doors, and mirror with shelf and recessed LED strip lighting
- Under-sink drawers for additional storage
- Polished quartz stone countertop and backsplash
- Kohler under-mount sink with brushed nickel Kohler Elate faucet
- Kohler WaterSense high-efficiency toilet with quiet-close seat
- Soaking tub with spout, shower faucet and pressure-balancing valve
- Porcelain tile flooring and tub / shower surround

Elevated Ensuite

- Finishes consistent with the main bathroom
- Spacious walk-in shower with luxurious glass enclosure
- Brushed nickel Kohler rainfall shower with hand-held sliding shower head

Peace of Mind

Home warranty coverage:

- 2-year materials and labour warranty
- 5-year building envelope warranty
- 10-year structural warranty
- Dedicated Strand Customer Care Team

Luxurious Amenities

14,000 square feet of private indoor and outdoor wellness-focused amenity space

Ground Level

- Spacious lobby with grand double-height ceiling, soft seating and water station
- Secure mailroom
- Access to landscaped exterior and private dog-walking area

Level 4

- Fully-equipped indoor fitness centre
- Outdoor secret garden and children's play area

- Landscaped picnic area with a BBQ and harvest tables
- Outdoor firepit and seating
- Games and social lounge

Level 29

- Rooftop Sky Spa including:
 - Outdoor hot and cold plunge pools

- Outdoor rainfall shower
- Outdoor lounge with firepit
- Tranquil yoga / meditation room
- Tea station
- Steam room and sauna
- Men's and women's spa-style changerooms

- Sky Garden with loveseats, hammocks, harvest tables, and outdoor BBQ
- Social Lounge with fully equipped kitchen, dining space, and outdoor terrace
- Business Centre with individual work pod, open coworking area and dual-purpose meeting and dining boardroom

General

- 3 high-speed elevators for easy access throughout the building
- All parking stalls EV ready
- Urban bike storage area
- Bike repair room with bike wash station
- Dog wash station
- Car wash station



THE AMENITIES



AN EXCLUSIVE COLLECTION OF WELLNESS-FOCUSED AMENITIES



Private Dog-Walking Area



Games Room



Fitness Centre



Child Play Area



BBQ & Picnic Space



Outdoor Hot & Cold Plunge Pools



Outdoor Rainfall Shower



Steam Room & Sauna



Yoga & Meditation Room



Tea Room



Social Lounge



Sky Garden



Outdoor Gas Firepit Lounge



Meeting Room



Soundproof Work Pod



A PHILOSOPHY *OF GREAT DESIGN,* FOR ALL.

Deeply rooted in Vancouver for over four decades, Strand has developed dozens of award-winning communities while delivering over 25,000 homes across North America.

With a strong commitment to timeless design that complements a global sensibility, Strand brings our knowledge and experience back to our home city, deepening our investment in the future of the region.

DEEP ROOTS. BIG PLANS.

Connect with us

stranddev.com

[@stranddev](https://twitter.com/stranddev)



WORKING IN HARMONY AT ALINA

Architecture

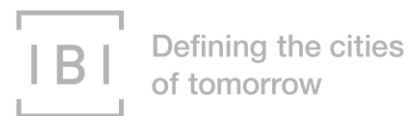

IBI Group is a technology-driven design firm, providing architecture, engineering, planning, systems, and technology services to our clients for nearly 50 years. With more than 3,200 professionals located in over 60 offices around the world, we create responsive, resilient spaces and smart urban environments by bringing the established capabilities from our Intelligence practice into our core Buildings and Infrastructure businesses. From high-rises to hospitals, and transit systems to schools, we shape the way people live, work, move, learn, and heal in the cities of tomorrow.

Interior Design

STE. MARIE

Ste. Marie is a commercial interior design studio and creative consultancy. We lead concept development and interior design for mixed-use, hospitality, residential and retail projects, globally. We are sought for our vision of the world as it could be.

Landscape Architecture

eta landscape architecture

eta landscape architecture is an award winning professional team whose strengths lie in offering the technical, graphic, written, and verbal communication skills necessary to guide our projects through all levels of the planning, design, approval, and construction process. Whether it is a large or small component of the overall project, the value of landscape to the users of every project is explored and developed to enhance their lives and provide a better understanding of the natural environment. Our approach is a multidisciplinary one where we see our role within the project team as providing a unified ground plane, extending the landscape up onto the building roof areas, and integrating the project into its context.

Construction

AXIOM
BUILDERS

Axiom Builders is committed to building exceptional projects to exceptional standards. As a forward-thinking construction partner, our dedicated team and skilled tradespeople operate everyday with the end user in mind. The result: a first-in-class product that homeowners will fall in love with.

